



Slider M50
SALICE

Slider M50



M50 are coplanar system for full-height cabinets with doors weighing up to 50 kg respectively.

Thanks to the exclusive patented design of the Slider series, sliding is intuitive, smooth and silent.

M50 is characterised by its versatility: suitable for many types of setting, it can be used with doors 33 or 17 mm above the ground.

M50 is ideal for wardrobes and storage cabinets in offices and shops.



Slider M50





Technical information

Coplanar two-door system with linear magnetic damper.

M50 is ideal for wardrobes and storage cabinets in offices and shops.

Individual door properties:

- max. weight per door: 50 Kg
- width: min. 800 mm max. 2000 mm
- height: min. 1200 mm max. 3000 mm

• thickness:

- with recessed upper adjuster
min. 18 mm, max. with handle 45 mm
- with external upper adjuster
min. 18 mm, max. with handle 40 mm

• material: wood

- Clipper frames can be used

Door adjustment:

- vertical adjustment ± 5 mm
- horizontal adjustment ± 3.5 mm
- front adjustment: - upper ± 3 mm
- lower ± 3 mm

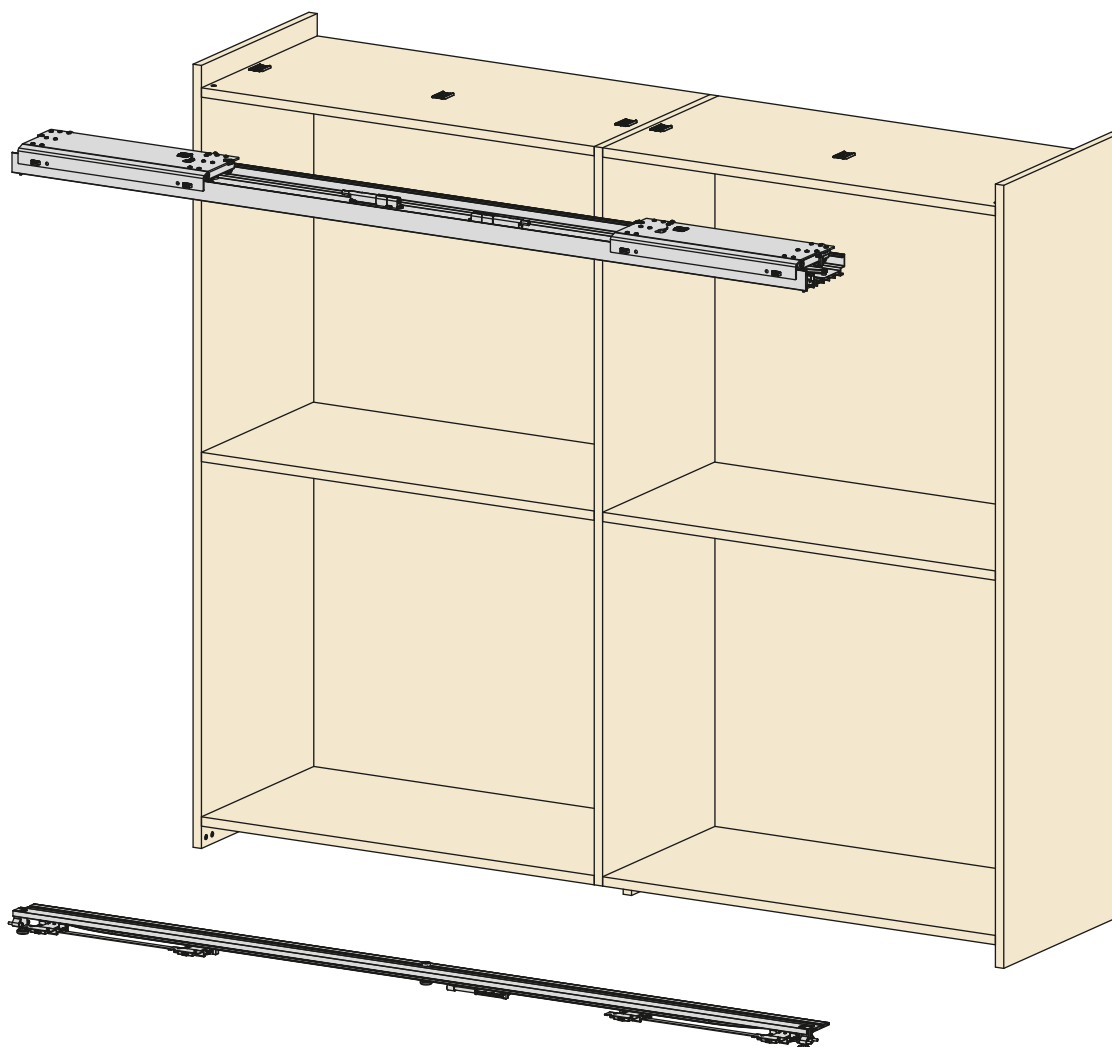

Key feature

- Soft closing with magnetic technology.
- Very easy to assemble.
- Super-smooth cushioned opening and closing
- High reliability, tested to 100,000 cycles.

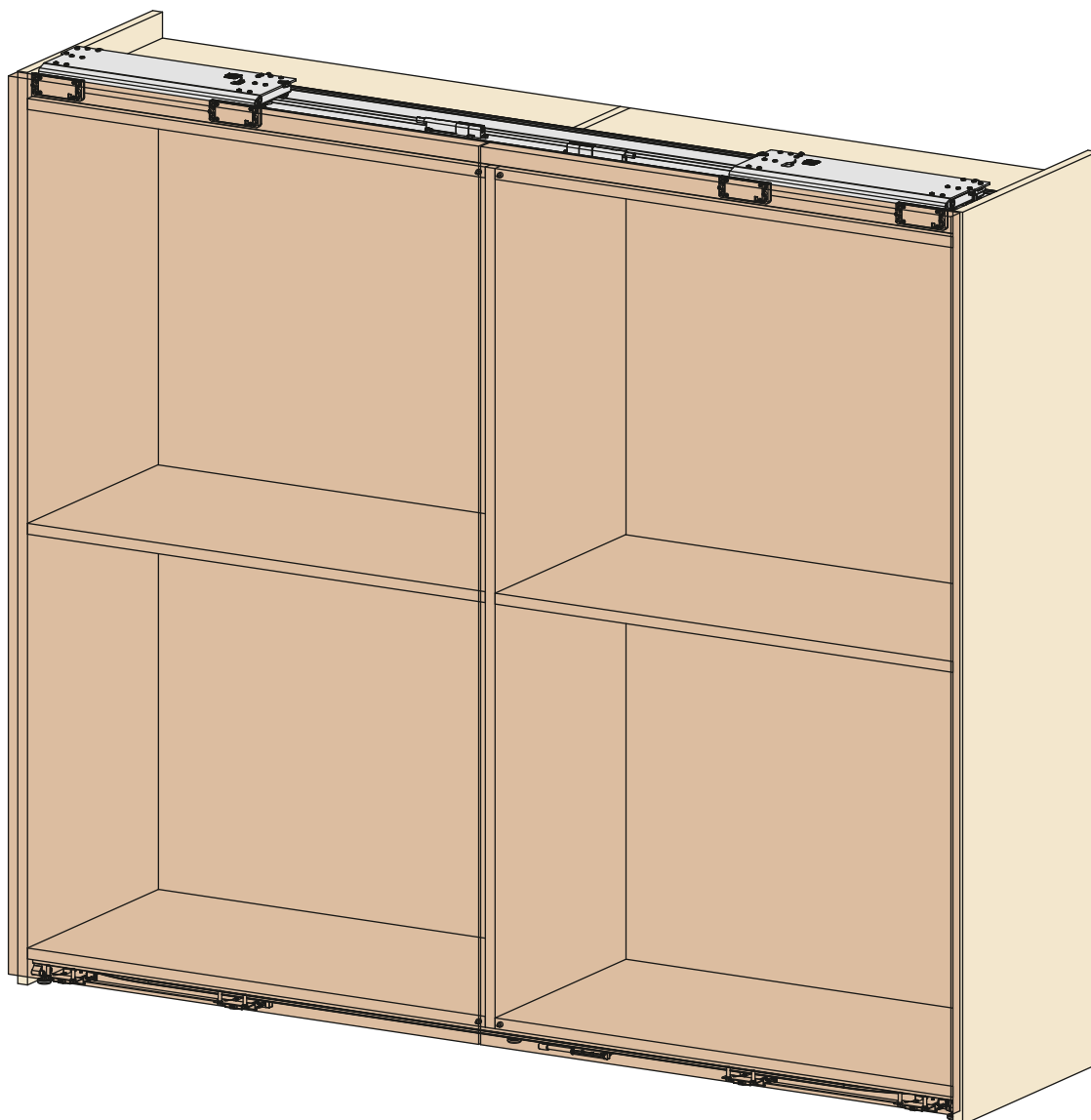

17 (M50)

Surface-mounted adjusters

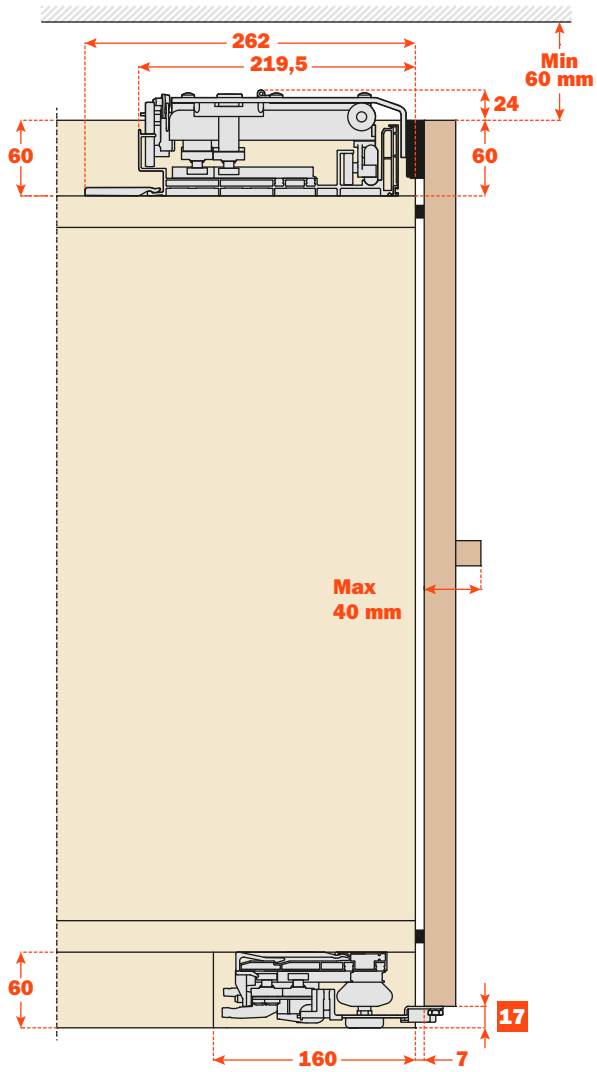

17 (M50)

Recessed adjusters

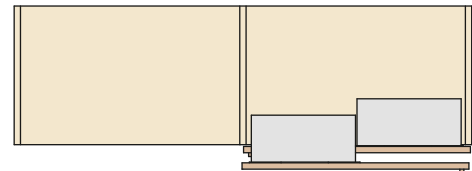
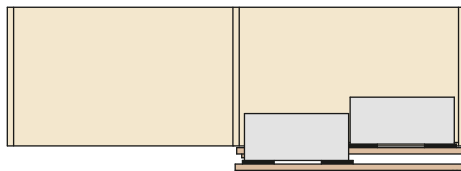
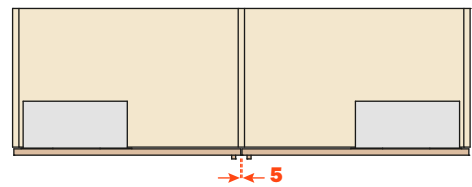
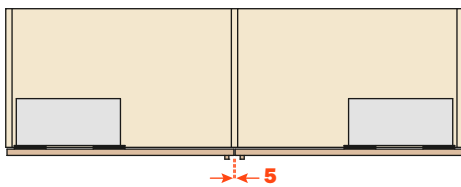
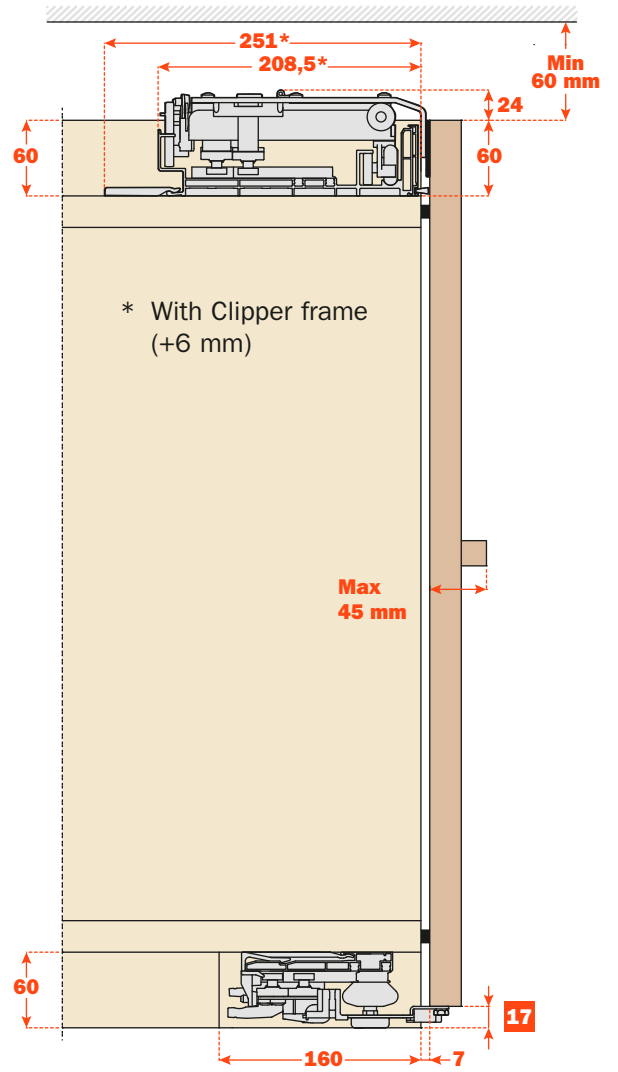

- Types of assembly

33 (M50)

Surface-mounted adjusters

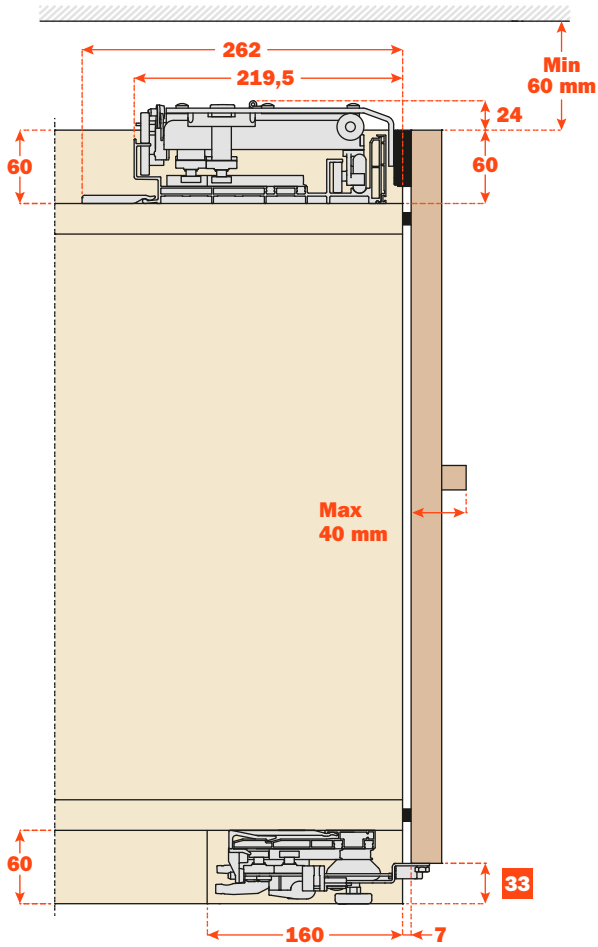

33 (M50)

Recessed adjusters

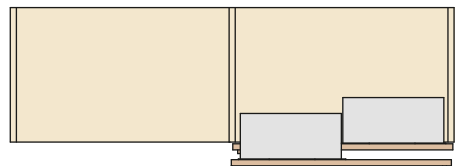
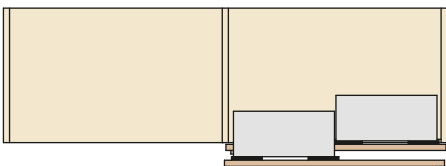
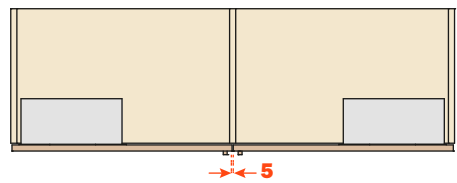
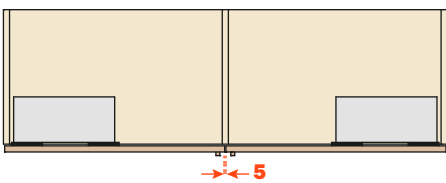
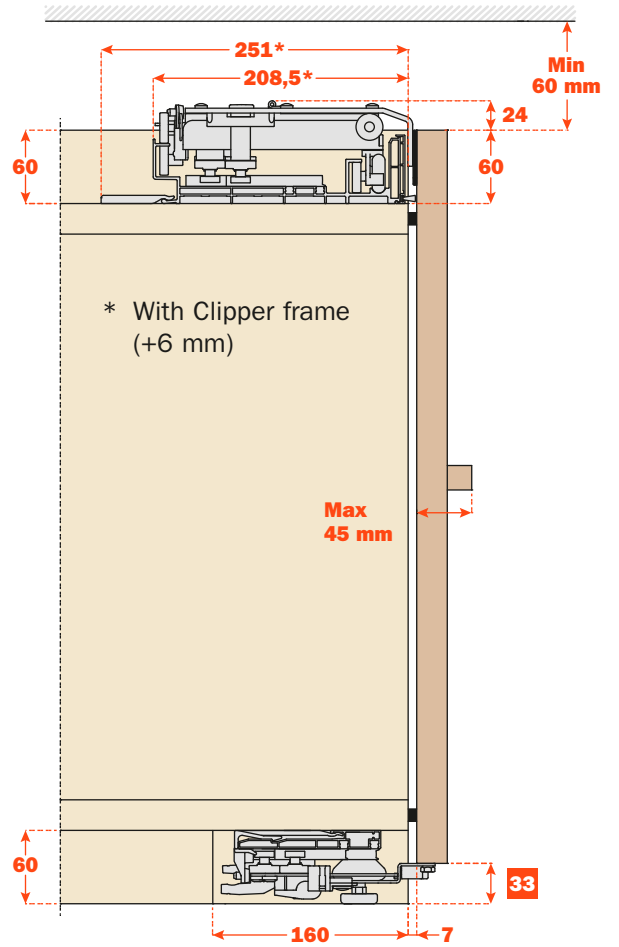

Customised systems

Slider M50 can be supplied in customised lengths i.e. designed for installation on cabinets with internal width (**LI**) equal to the length of the slider rail (**CP**).

Attention: clients can determine the extent to which the door will open based on variable **RAA** (distance between the central panel and edge of the door).

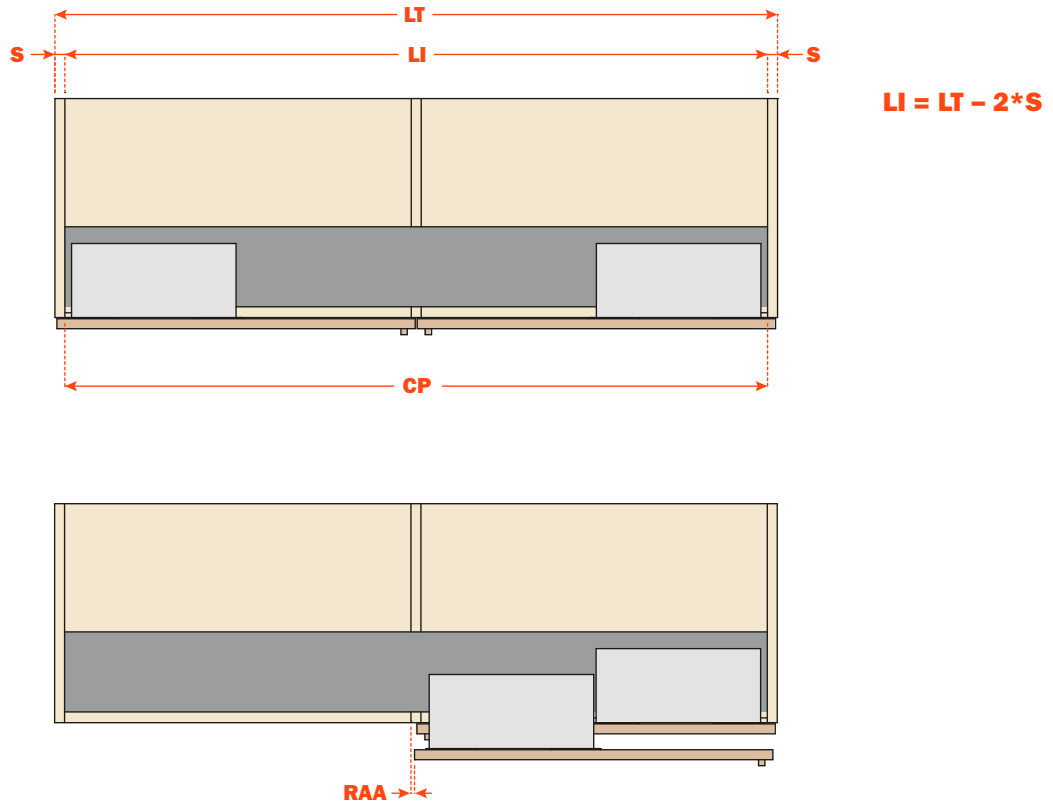

Standard

Slider M50 mechanisms are available in standard lengths i.e. designed for installation on cabinets with internal widths (**LI**) that measure up to 200 mm longer than the slider rail (**CP**) (Fig. **A**).
 Attention: The opening of the doors may be restricted (see formula in fig. **B**).

Fig. **A**

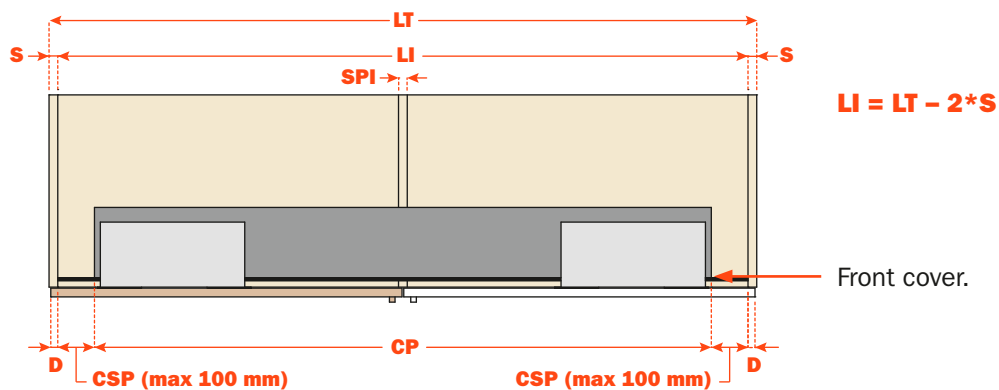
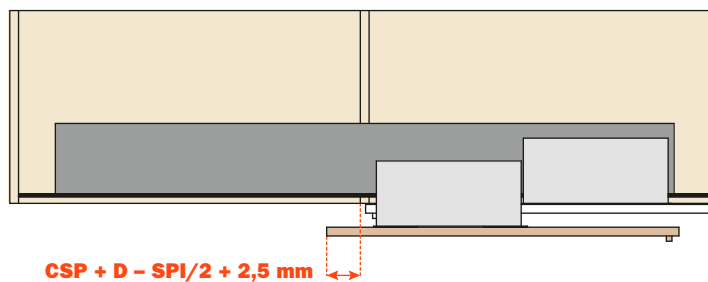
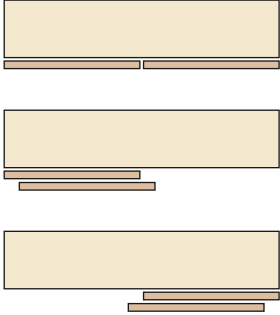

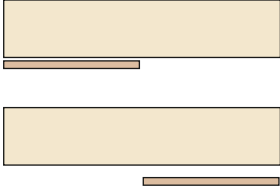

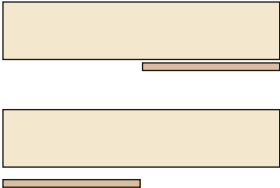

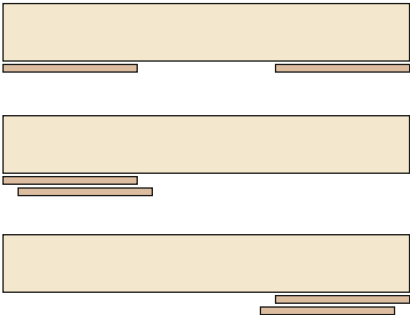

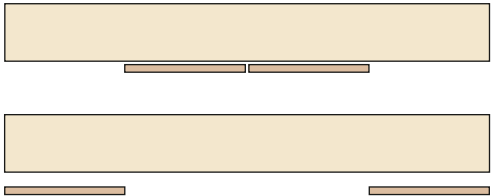



Fig. **B**



Description		Part number	LI (mm)	CP (mm)
Slider M50 2 doors	SM16-18	VE51FB01600NN	1600÷1799	1599
	SM18-20	VE51FB01800NN	1800÷1999	1799
	SM20-22	VE51FB02000NN	2000÷2199	1999
	SM22-24	VE51FB02200NN	2200÷2399	2199
	SM24-26	VE51FB02400NN	2400÷2599	2399
	SM26-28	VE51FB02600NN	2600÷2799	2599
	SM28-30	VE51FB02800NN	2800÷2999	2799
	SM30-32	VE51FB03000NN	3000÷3199	2999
	SM32-34	VE51FB03200NN	3200÷3399	3199
	SM34-36	VE51FB03400NN	3400÷3599	3399
	SM36-38	VE51FB03600NN	3600÷3799	3599
	SM38-40	VE51FB03800NN	3800÷3999	3799

<p>Standard</p>		<p>Slider M35 Slider M50</p>	 <p>Slider M35</p>
<p>One</p>		<p>Slider M35 Slider M50</p>	 <p>Slider M35</p>
<p>One</p>		<p>Slider M35 Slider M50</p>	 <p>Slider M35</p>
<p>Step</p>		<p>Slider M35 Slider M50</p>	 <p>Slider M35</p>
<p>Reverso</p>		<p>Slider M35 Slider M50</p>	 <p>Slider M35</p>

ARTURO SALICE S.p.A.

VIA PROVINCIALE NOVEDRATESE, 10
22060 NOVEDRATE (COMO) ITALIA
TEL. 031 790424
FAX 031 791508
info.salice@salice.com
www.salice.com

BORTOLUZZI SISTEMI S.p.A.

VIA CADUTI 14 SETTEMBRE 1944, 45
32100 BELLUNO ITALIA
TEL. 0437 930866
FAX 0437 931442
info@bortoluzzi.com
www.bortoluzzi.com

DEUTSCHE SALICE GMBH

RUDOLF DIESEL STR. 10
POSTFACH 1154
74382 NECKARWESTHEIM
TEL. 07233 9807-0
FAX. 07233 9807-16
info.salice@deutschesalice.de
www.deutschesalice.de

SALICE UK LTD.

KINGFISHER WAY
HINCHINGBROOKE BUSINESS PARK
HUNTINGDON CAMBS PE 29 6FN
TEL. 01480 413831
FAX. 01480 451489
info.salice@saliceuk.co.uk
www.saliceuk.co.uk

DEUTSCHE SALICE GMBH

VERKAUFSBÜRO NORD
RINGSTRASSE 36/A30 CENTER
32584 LÖHNE
TEL. 05731 15608-0
FAX. 05731 15608-10
vknord@deutschesalice.de
www.deutschesalice.de

SALICE AMERICA INC.

2123 CROWN CENTRE DRIVE
CHARLOTTE NC. 28227
TEL. 704 8417810
FAX. 704 8417808
info.salice@saliceamerica.com
www.saliceamerica.com

SALICE FRANCE S.A.R.L.

ROUTE DE GOA ZAC LES 3 MOULINS
06600 ANTIBES
TEL. 0493 330069
FAX. 0493 330141
info.salice@salicefrance.com
www.salicefrance.com

SALICE CANADA INC.

3500 RIDGEWAY DRIVE,
UNIT#1
MISSISSAUGA, ONTARIO, L5L 0B4
TEL. 905 8208787
FAX. 905 8207226
info.salice@salicecanada.com
www.salicecanada.com

SALICE ESPAÑA, S.L.U.

CALLE COPÉRNICO, 11
POLÍGONO INDUSTRIAL
COLL DE LA MANYA
08403 GRANOLLERS (BARCELONA)
TEL. 938 45 88 61
FAX 938 49 11 97
info.salice@saliceespana.es
www.saliceespana.es

**SALICE CHINA
(SHANGHAI) CO. LTD.**

1st FLOOR, B1 BLDG 928 MINGZHU ROAD
XUJING, QINGPU DISTRICT
SHANGHAI 201702 - CHINA
Tel. 021 3988 9880
Fax 021 3988 9882
info.salice@salicechina.com
www.salicechina.com

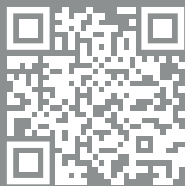
**Digital contents:**

- **Technical pamphlet in Pdf format**

We reserve the right to change technical specifications without notice.

DOCASS011ENG
Ed. 02 - 03/2019

